

# Start Here

## ▼ Installing your Microtek ArtixScan DI 2125c

### 1

## Unpack Contents

Unpack your scanner package and check for major components.

1. ArtixScan DI 2125c scanner
2. Power adapter
3. Software CDs/DVDs
4. Hi-Speed USB cable

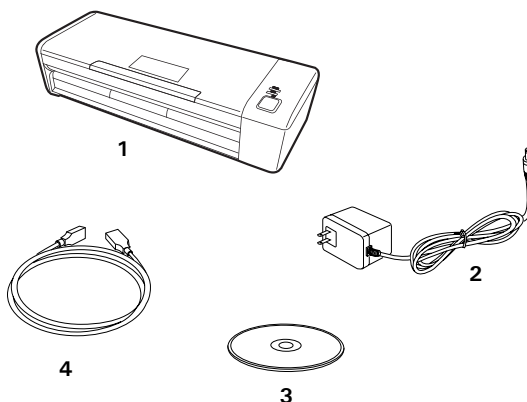

### 2

## Install Software

**Important:** You must install software before connecting your scanner.

Always close any open programs and turn off Anti-virus utilities before installing software.

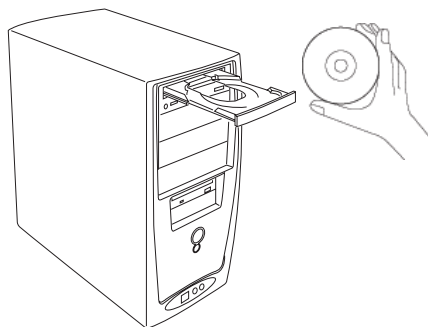

- A. Turn on your computer.
- B. Place the **Microtek Software CD/DVD** into a drive, and follow the on-screen instructions to install the scanner driver and software.
- C. Restart your computer at the end of all software installation.

**NOTE:** If the Microtek Software Installer screen does not come up automatically, double-click the following in succession: "My Computer"; the CD/DVD-ROM icon; then cdsetup.exe to start the installer program.

# 3

## Connect Scanner

### To the power adapter

- A. Connect the power adapter to the back of the scanner.
- B. Plug the other end of the power adapter into the a wall outlet or other power source.

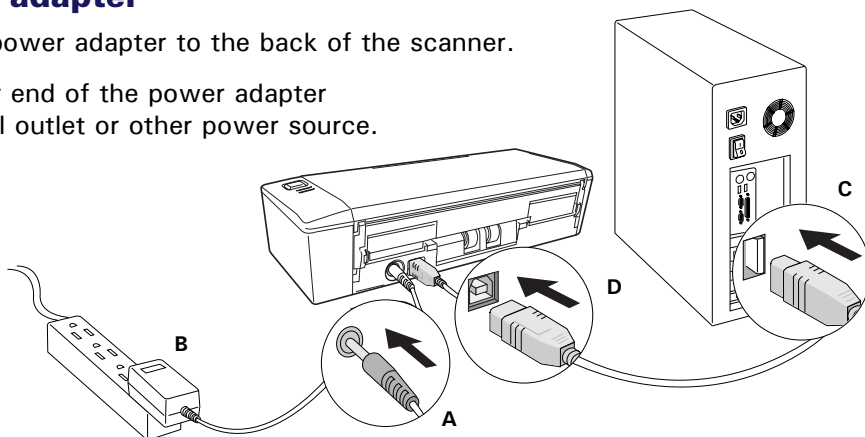

### To the Hi-Speed USB cable

- C. Connect one end of the cable to your computer.
- D. Connect the other end of the cable to the scanner's USB port.
- E. Open top cover (Document Feed Tray) to turn on the scanner.

Once the scanner is detected by your system, the LED (green) will brighten, and the scanner is ready to scan.

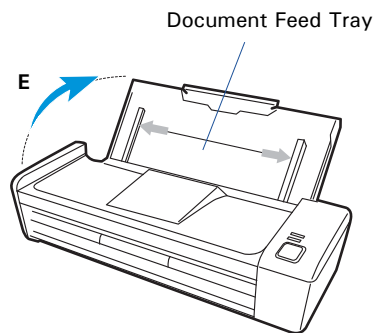

## Customize the Function Button

The ArtixScan DI 2125c is equipped with one programmable function button, F1, that can be customized to automate a number of predefined operations, such as scanning to a file, sending an image to your printer, scanning for OCR, etc. Customizing is done through the *Save Settings to Function Button* command in the ScanWizard DI, refer to the ArtixScan DI 2125c User's Manual for more details.

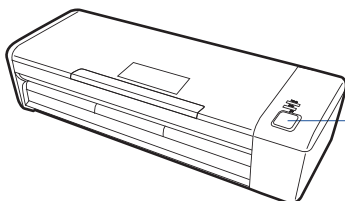

- **F1:** Customizes the function button to perform your preferred functions.

## Position Documents

The scanner supports scanning of document in various materials, such as A4 printouts, insurance papers, legal documents, postcards, credit cards, business cards, and etc. A stack of up to 20 sheets can be fed in the scanner's Document Feed Tray. Paper sizes can range from 3.15" x 2.1" (80 mm x 52 mm) to 8.5" x 65" (216 mm x 1651 mm).

### To load a stack of documents

1. Open the top cover (Document Feed Tray) of the scanner.
2. Pull out the Tray Extender for better paper support if needed.

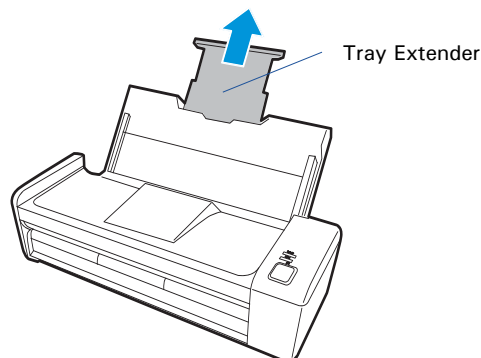
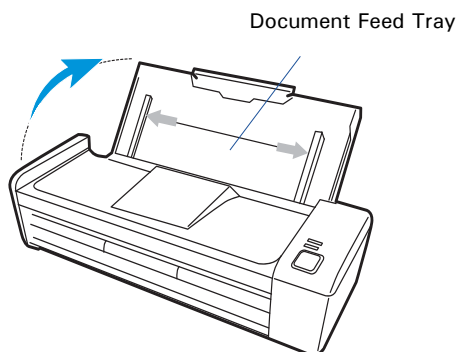

3. Load and center the stack of documents onto the Document Feed Tray, with the side to be scanned facing down and the top edge facing toward the feeder. Then, slide the two Guide Arms toward the stacked papers if needed.

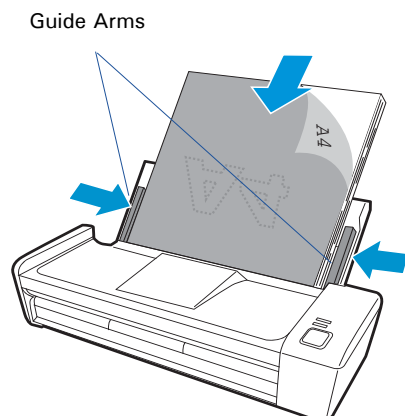

### To load cards

1. Open the Document Feed Tray.
2. Load the card face up into the Card Tray located at the bottom of the Document Feed Tray, with the top edge facing toward the feeder.
3. Align the card against the left edge of the Card Tray.

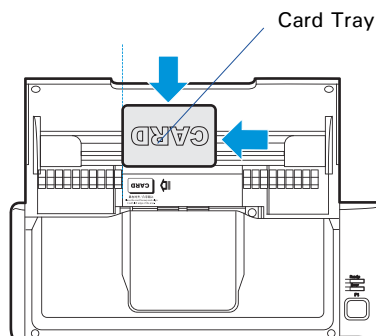

## Scan a Stack of Documents

1. Place the stack of documents to be scanned on the Document Feed Tray of the scanner.

**WARNING:** Do not place photo paper or fragile sheets of paper on the feed tray, as doing this will damage the original photo or frail papers during the feeding process.

2. Launch ScanWizard DI — either as a stand-alone by clicking the program icon, or by using the *File-Import* or *Scan* command from an application program.
3. Specify your scanning requirements in the ScanWizard DI control panel.
  - a) Select ADF (Simplex) or ADF (Duplex) in the *Scan Source* drop-down menu as your image input device.
  - b) Select the appropriate image type (e.g., Black & White) in the *Scan Type* drop-down menu as your image output type.
    - Select RGB Color (24 bits) to scan the image in color.
    - Select Grayscale (8 bits) to scan the image in grayscale.
    - Select Black & White (1 bit) to scan the image in black-and-white.
  - c) Select a dimension in the *Paper Size* drop-down menu as your preview image size.
  - d) Select a desired resolution in the *Resolution* drop-down menu for your image output resolution.
  - e) If Auto-crop & Auto-deskew is selected, the scanner automatically detects the size of the original image, crops the full scan frame to fit the image, and removes unwanted black borders after the scan, as well as corrects the distorted image for proper alignment. .
4. If necessary, check the Remove Blank Page to remove blank images in a batch. Check the Remove Punch Hole to take away unwanted punch holes on the scanned and saved document images.
5. Select the image type (e.g., Text) in the *Attribute* drop-down menu as your image type.
  - Select Line Art to scan line art images (images in one color or in black-and-white, such as logos or mechanical blueprints).
  - Select Photo to scan color prints.
  - Select Text to scan text.
6. If necessary, adjust image quality by using the image correction tools.

## Scan a Stack of Documents (cont.)

### 7. Click the *Scan* or *Scan To* button to start multiple-sheet, automatic scanning.

If ScanWizard DI is launched as a Plug-In from an image-editing program, the scanned image is delivered after the scan to your application, where the image can be saved, printed, or modified further.

If ScanWizard DI is launched as a stand-alone program, the scanned image can be saved after the scan to a file, opened in an image-editing program, or sent to a printer.

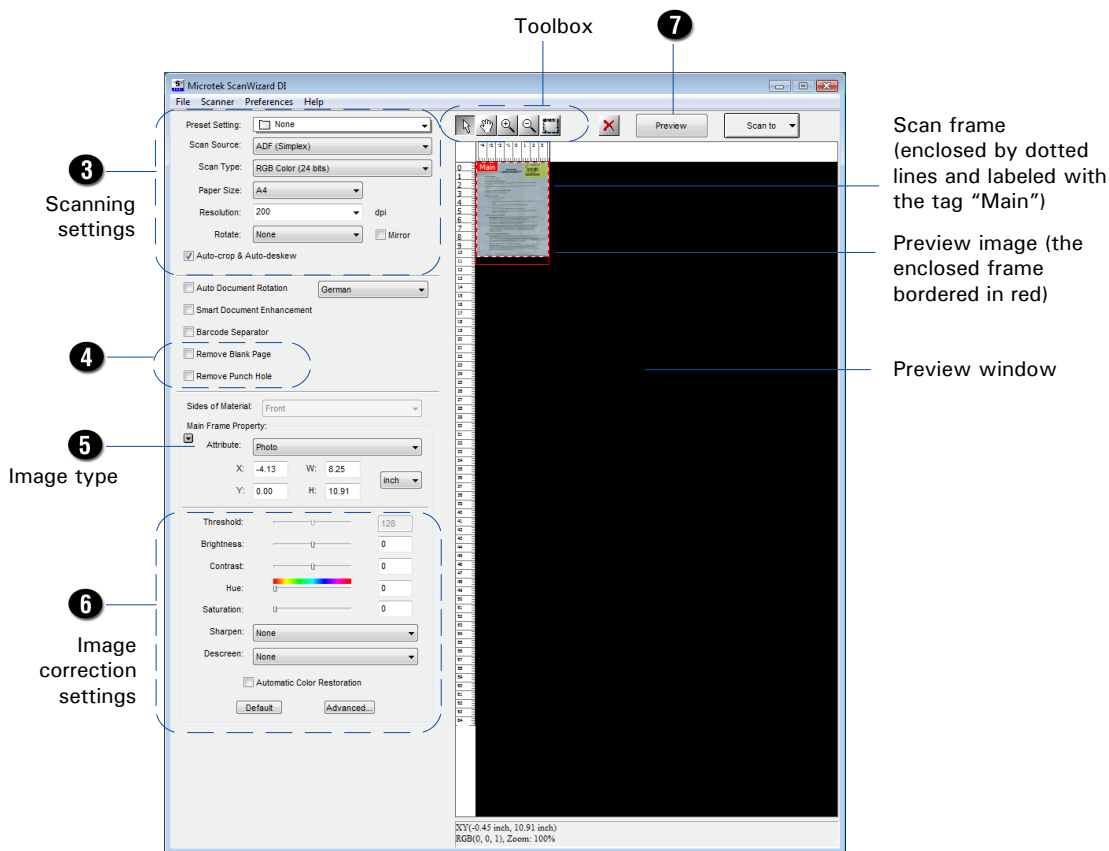

**NOTE:** For details on other scanning scenarios applicable to the ArtixScan DI 2125c, refer to the ArtixScan DI 2125c User's Manual.

## Fixing Paper Jams

1. Hold the two sides of the scanner cover and pull up them firmly to open the scanner cover.

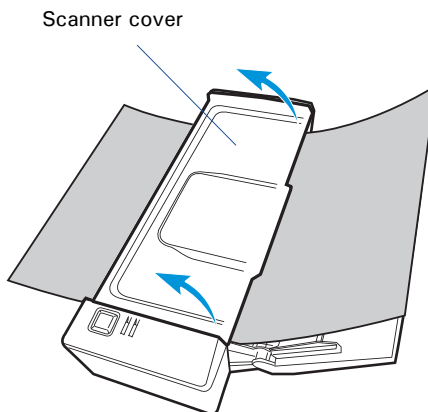

2. Remove the jammed paper by pulling out it in the ejecting direction.

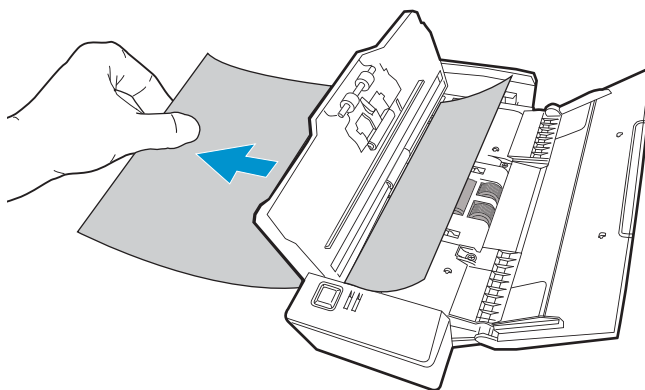



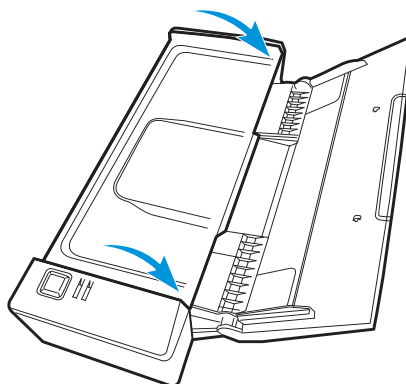

3. Close the scanner cover. You would hear a click sound when the scanner cover returns to its original position.



**Note:** Do not take out a jammed paper by force from the scanner when the scanner cover closes. If doing so, it may damage the rollers and cause the scanner work improperly.

## Problems?

The LEDs on the top panel of the scanner indicates the status of the scanner.

	<b>Green On</b>
	Ready to scan.
	<b>All On</b>
	Scanning errors happens.
	<b>All Off</b>
	Scanner is off.

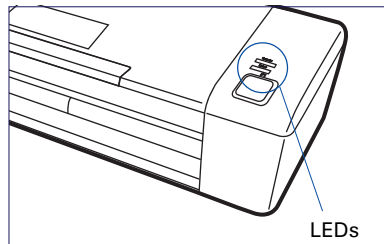

**First, make sure that you have followed Steps 1 to 3 as described in this guide (unpack, install, connect). Then if your problem is listed here, try the suggested solution.**

**1. No light comes on when the scanner is already supplied with power.**

Make sure your scanner is connected to your computer and plugged into a power source.

Make sure the Document Feed Tray is opened.

**2. The Add/Remove Hardware Wizard appears on your screen.**

Click the "Cancel" button and close the ScanWizard DI Control Panel. Disconnect the Hi-Speed USB cable from the back of your computer, and refer to the installation instructions in this guide or the ArtixScan DI 2125c User's Manual.

**3. When trying to scan, an error message appears on your screen that reads, "Can't Find Scanners".**

Make sure your scanner is connected to your computer and plugged into a power source (see Step 3).

Uninstall and reinstall the ScanWizard DI software.

**4. After clicking scan, a blank screen appears.**

Uninstall and reinstall the ScanWizard DI software.

**5. When trying to scan, an error message appears on your screen that reads, "Code - 206, ADF paper jam or roller failure."**

Click OK first; then open the scanner cover, as illustrated in the pervious section "Fixing Paper Jams".

- If the problem is occurring from a paper jam, follow the procedures laid out in the "Fixing Paper Jams" section of this guide.
- If the problem is occurring from situations other than a paper jam, follow the procedures laid out in the "Position Documents" section.

Finally, close the scanner cover and restart scanning.

# Do You Need Assistance?

## Manuals

If you have additional questions and need further instruction or information, we provide electronic manuals for:

1. Using your ArtixScan DI 2125c Scanner (User's Manual)
2. Using the ScanWizard DI scanning software (Reference Manual)
3. Using the bundled third-party software

To access the electronic manuals: Insert the scanner's software CD/DVD into your computer's CD-ROM/DVD-ROM drive. Next, locate and click the "Manuals" option when the software installer window appears on your screen. Finally, select and click the title of the manual you wish to view. manual you wish to view.

## Missing Items

If your package is missing items, please call the Microtek Customer Service Department.

## Drivers & Software Upgrades

After you finish the installation of software, if you found that the installed drivers and software cannot run your product or your computer system properly later, please go to the Microtek **Download Service** site at [ww7.microtek.com.tw/service.php](http://ww7.microtek.com.tw/service.php) to download and install any updates you may require.

For additional information about Microtek products, please visit our website at [www.microtek.com](http://www.microtek.com).

### Power Adapter

Use only power supplies (AC/DC adapters) listed below:

Voltage	Manufacturer	Model No.
100V to 240V	APD	WA-18G12U (EU/TWN)
100V to 240V	APD	WA-18G12G (EU)
100V to 240V	APD	WA-18G12K (UK)
100V to 240V	APD	WA-18G12N (AU)
100V to 240V	APD	WA-18G12S (Korea)
100V to 240V	APD	WA-18H12

**NOTE:** Please make sure that the electrical outlet to where the scanner will be connected is nearby and readily accessible.

Copyright © 2013 Microtek. Microtek, ScanMaker, ArtixScan, ScanWizard and ColoRescue are trademarks or registered trademarks of Microtek International, Inc. All other trademarks or registered trademarks are the property of their respective holders. Specifications, software and hardware bundles are subject to change without notice. Delivery of technical support services subject to change without notice. Not responsible for typographical errors.

